

# GREEN & ENVIRONMENT AUDIT REPORT 2015-16

Date 02/05/16 to 09.05.16

## 1. Aim & objective

- a) Survey of pollution and environment of college campus.
- b) Practical education regarding pollution as the students of biological science
- c) Beautification of college campus
- d) Clearness in campus
- d) Continuous watch on waste management.

## 2. Location of the college

Gopalpur College, Gopalpur, Balasore

Mouza- Sarangpur, Po-Jageswer pada

Via- Gopalpur, Ps- Khantapara, Dist- Balasore

State- Odisha

Plot no. 06- (1 acre) , Plot no-07 (81 decimel) and plot no- 1690,1691,1695,1696,1697

With total area -13.5 acre

Year of establishment 1978

## 3. Mode of survey

- a) Pond- 90'x80'x6'
- b) General garden
- c) Greenies around pond

## 4. Study of Pollution

- Chemistry lab- This lab conduct diff. Chemical Experiment and release for order containg  $SO_2$   $Cl_2$   $NH_3$   $(NO)_x$   $CO_2$  etc.
- A number of two wheelers comings to the collage daily. They release vehicular Exhaust
- BCR, GCR, SCR, office of this college release pungent odour having on  $H_2S$ .
- A huge number of vehicles pass through the nearby salt roads which cause air pollution.

## 5. Other difficulties

- This college is very prone to cyclones, flood in each year. A number of plants are uprooted or dwindled.
- College is only 10 km away from seashore.
- A salt road passes close to the college. The vehicles release air pollutants which enter into college campus.

### Remedial measures

Waste management: - The official wastes like cartons, waste paper, fallen leaves, cow dung are collected and dumped into a pit. These are biologically degraded, the humus is collected and used in garden and Plantation.

### College Garden

To beautify the campus diff. Type of medicinal plants, flowering plant are planted. Seasonal flower are also planted in each seson. thePermanent flowering plant are croton, Arcania, pasiflora, peniwinkle, henna, Jasmine, gardenia, chamap jasmine cycas, might jasmine, rose etc.

### Future plan

Different type of plant are to be planted around the play ground and in also in the campus of Subhadra ladies hostel.

### Appraisals repost

Audit is done by Eco club established in the Department of Botany. The durability or effectiveness of such report is one year in normal condition

**Green population study**

Name	Full grown	Young	Sapling	Uprooted	Total
Acacia	130	10	10	00	150
Bakul	15	13	07	00	35
Jamun	03	00	00	00	03
Sinisha	07	00	00	00	07
Betelnut	07	03	00	00	10
Paper plant	02	00	00	00	02
Neen	50	10	00	00	60
Kanchan	01	00	00	00	01
Sik Cotton	07	00	00	06	13
Radhachuda	10	02	01	00	13
Arjun	03	00	00	00	03
Batapi	-	01	-	-	01
Chhagalbati	01	-	-	-	01
Coconut	04	-	-	-	04
Red wood tree	08	-	-	-	08
Banyan	00	01	-	-	01
Jui	02	-	-	-	02
Mango	18	03	02	-	23
Sapota	08	01	-	-	09
Margosa	00	03	-	-	03
Champak	02	-	-	-	02
Nageswar	01	00	00	00	01
Debadaru	52	07	02	-	61
Guava	02	02	-	-	04
Muchakund	01	-	-	-	01
Tamarind	01	-	-	-	01
Janglibadar	01	-	-	-	01
Teak	20	25	02	-	47
Euqualiptes	10	01	-	-	11
Arcania	03	-	-	03	06
Palmyra palm	04	02	-	-	06
Prunus	-	03	-	-	03
Diospyros	-	01	-	-	01
Buanla	09	06	-	-	15
Karuna	00	01	-	-	01
<b>Total</b>	<b>384</b>	<b>98</b>	<b>23</b>	<b>06</b>	<b>511</b>

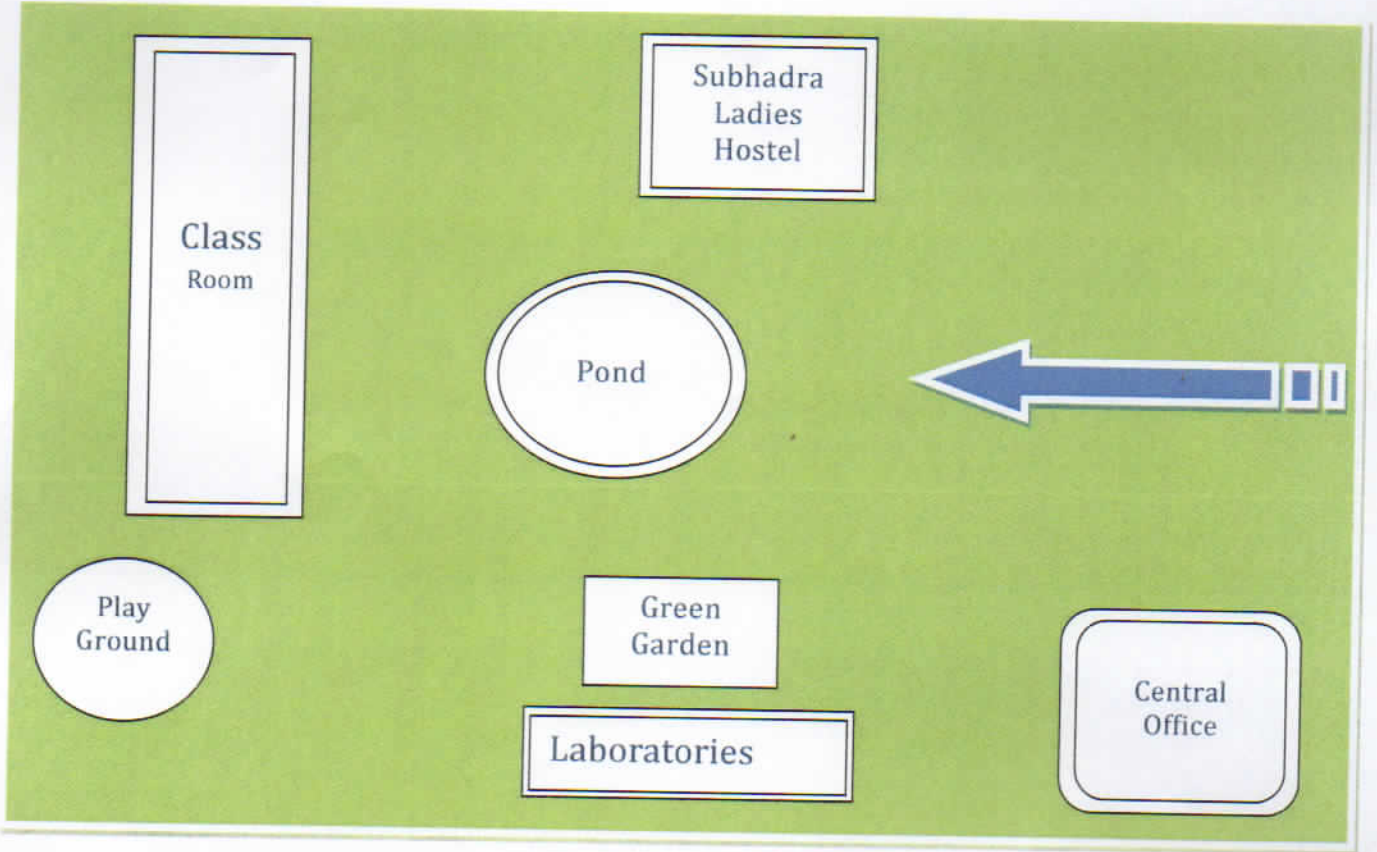

*Unesh chand...*  
Signature of  
Green Audit Officer

*Nanendras...*  
*Nell*  
Principal  
Gopalpur College, Gopalpur, Balasore  
Gopalpur, Balasore.